



# ROOFING SHINGLES

PRODUCTION CATALOGUE



# MIDA roofing shingles









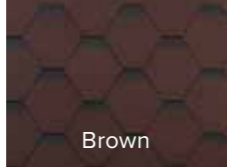

MIDA roofing shingles are modern shingles with high aesthetic and operational parameters which have improved properties and create a unique relief of the roof.

Quality management system certified to ISO 9001:2015

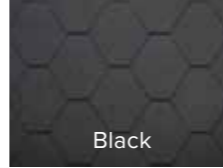
## ULTRA series EN 544

ULTRA is the only series made with SBS modified asphalt that gives exceptional physical and mechanical properties to the product and improves its resistance to low temperatures. Due to its enhanced flexibility ULTRA is also the best choice for the most complex construction design.



<b>SONATA SAMBA</b> 					
	Red	Brown	Green	Grey	Black
<b>ACCORD JIVE</b> 					
	Red	Brown	Green	Grey	

## CLASSIC series EN 544

CLASSIC is a time tested traditional product that stays popular due to its reasonable price-quality ratio. Coming in various color hues CLASSIC shingles allow to choose roofing that complements any architectural design. It has the benefit of containing a high-quality asphalt binder.



<b>SONATA QUADRILLE</b> 					
	Red	Brown	Green	Grey	Black
<b>ACCORD PRAGA</b> 					
	Red	Brown	Grey	Black	
<b>TANGO SUPER</b> 					
	Red	Brown	Green	Red plus	Black
<b>TRIO SUPER</b> 					
	Red	Brown	Green	Grey	Black

**NOTE:** Actual product colors may vary slightly from the colors shown in the catalogue. If color hue is critical for you, please request full-size samples before making your final choice.

\* For more information about warranty visit [www.mida.it](http://www.mida.it).



## YOGA series ETA 12/0234

Thin and very flexible shingles on SBS modified bitumen. YOGA series is designed for those, who appreciate long-lasting visual aesthetics, care for ecology and recognize the value in easy installation process.



<b>HEXAGONAL</b> 					
	Red	Brown	Green	Grey	Black
<b>BEAVER PLUS</b> 					
	Red	Brown	Green	Grey	Black
<b>TRIO</b> 					
	Red	Brown	Green	Grey	Black

## STANDARD ROCK series ETA 12/0264

STANDARD ROCK series – economical choice with assured quality and reliability.



<b>HEXAGONAL</b> 					
	Red	Brown	Green	Grey	Black
<b>BEAVER PLUS</b> 					
	Red	Brown	Green	Grey	Black
<b>TRIO</b> 					
	Red	Brown	Green	Grey	Black

\* For more information about warranty visit [www.mida.it](http://www.mida.it).





**MIDA roofing shingles**



**MIDA hip & ridge & starter shingles**

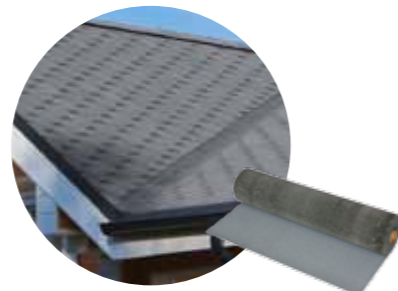

**Valley roll material MIDA UNIFLEKS EKM**



**Underlayment membranes**



**Ridge ventilation**



**Roofing nails**



**Adhesive for roofing shingles**



**Classic system**

The system is designed for the creation of a cold attic on pitched roofs of any complexity and configuration. MIDA roofing shingles are used as a roof covering.

**SYSTEM COMPONENTS:**

1. Rafter
2. Counter battens
3. Wood decking (OSB-3, plywood, wooden boards)
4. Underlay bitumen membrane
5. Adhesive for roofing shingles
6. MIDA roofing shingles

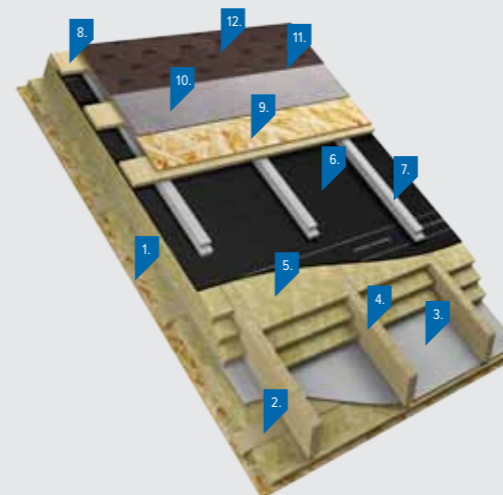

**Attic system**

The system is successfully used for the creation of an attic floor in low-rise buildings and cottages. MIDA roofing shingles are used as a roof covering.

**SYSTEM COMPONENTS:**

1. Attic interior finish
2. Counter battens
3. Vapor barrier membrane
4. Rafter
5. Stone wool
6. Superdiffusion membrane
7. Ventilation space battens
8. Counter battens
9. Wood decking (OSB-3, plywood, wooden boards)
10. Underlay bitumen membrane
11. Adhesive for roofing shingles
12. MIDA roofing shingles



## Accessories

### MIDA hip & ridge & starter shingles



Hip & ridge & starter shingles produced with SBS modified asphalt are extremely flexible; they are used for quick and easy installation of a starter row along eaves. These pre-cut shingles can be separated into three smaller pieces for further application on hips and ridges to add the perfect aesthetic finish to your roof. Maximum protection against wind, snow and rain is provided.

Available in a wide range of colors to match any chosen roofing color solution.

Dimensions: 1 m x 0,25 m

Coverage per a bundle: 12 lin. m (hips & ridge) and 20 lin. m (starter strip).

Color:

### Valley roll material MIDA UNIFLEKS EKM

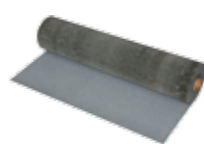

Used as waterproofing underlayment in roof valleys which are prone to leakages under snow and rain loads and thus require extra protection. This material is also used to seal joints between roofing and piping or vertical walls.

Dimensions: 1 m x 10 m

Color:

### Adhesive for roofing shingles



Provide extra adhesion of roofing shingles and other bitumen-based materials to such surfaces as brick, concrete, metal, wood, ceramic etc.

Operating temperature ranges from -5°C upto +40°C.

### Roofing nails



Anticorrosive roofing nails with circular cross-section for fastening of asphalt shingles to a wooden deck. Also used for mechanical fastening of roof components.

Head diameter ≥ 9 mm, nail diameter ≥ 3.5 mm, shank length – 20 mm, 30 mm.

## Recommended sets

MIDA ROOFING SHINGLES		SINGLE LAYER	ULTRA	CLASSIC	YOGA	STANDART ROCK
UNDERLAY		MIDA LIGHT G	●	●	●	●
		MIDA LIGHT S	●	●	●	●
BITUMEN MASTIC			●	●	●	●
NAILS		20 mm	●	●	●	●
		30 mm	●	●	●	●

## PHYSICAL AND MECHANICAL PROPERTIES

Properties	ULTRA	CLASSIC	STANDART ROCK	YOGA	MIDA LIGHT G	MIDA LIGHT S
Manufacturing standard	EN 544	EN 544	ETA 12/0264	ETA 12/0234	EN 13707	EN 13707
Type of polymer/modifier	SBS	—		SBS	SBS	SBS
Package of finished roofing, m <sup>2</sup>	3	3	3	2	1,2±0,1	1,2±0,1
Package weight, kg	28,5	27,0–33,0*	24,0-30,0*	16,8-20,2**	18,5	16
Weight of 1 m <sup>2</sup> of finished covering***, kg/m <sup>2</sup>	9,5	9,0–11,0	8,0-10,0	8,4-10,0	1,8 ±0,2	1,45 ±0,3

\* depends on the shape of cuts (SONATA, ACCORD, TRIO, TANGO)

\*\* depends on the shape of cuts (HEXAGONAL, BEAVER PLUS, 3TAB)

\*\*\*weight of 1 m<sup>2</sup> of roof covering for roof load capacity calculation; depends on the shape of cuts (sonata, accord, trio, tango)

## MIDA SELF KSK EN 13707

### self-adhesive bitumen rolled roofing

Easiest roof covering ever! MIDA SELF KSK bitumen rolled roofing is selfadhesive elastomeric bitumen membrane covering the entire surface. Installation of the rolled roofing is quick, simple and safe way to cover various roofs of private buildings, for instance, garden homes, storage sheds, car ports, pavilions, etc. All you have to do is to unroll, attach with nails, remove protective film and press!

- Self-adhesive
- Dimensions 0.5×5.0 m, 1×10 m
- Thickness approx 3.0 mm
- Weight 3,8 kg/m<sup>2</sup>
- Resistant to atmospheric effects
- Watertight
- Quick and simple installation
- For pitched roofs from 5°



Red



Green



Brown



Grey



Black







## WHY IS IT COMFORTABLE WITH MIDA ROOFING SHINGLES ALL YEAR ROUND?



### PERFECT FOR COMPLEX ROOFING DESIGN

Roofing shingles are a construction material for residential roofing applications that is used on roof slopes of 12° or greater. It is the smartest solution for a complex or intricate roof design.



### NOISE INSULATION

Multilayer coating and its specific components make extremely quiet roofing. The noise of rain, wind or hail hitting the roof will not torture you. Enjoy peace and quiet in your house!



### ALL-WEATHER

Our roofing shingles efficiently protect you from merciless heat as well as from freezing winds, and thus help to maintain comfort temperature inside all the year round! They are suitable for any climate with temperatures ranging from -70°C to +80°C.



### BASALT GRANULES SURFACE

The coating made of natural basalt retains color, does not fade in the sun and does not change its color during the whole service life.



### SNOW SLIDE PREVENTION

The rough structure of basalt pellets' surface prevents the snow from falling down from the roof and facilitates its gradual melting.



### LEAK RESISTANCE

After installation, shingles are caked together into monolithic roofing, ensuring absence of holes and complete leak tightness.

## PACKING LIST SHINGLES

Main characteristics		Quantity in the package, units / m <sup>2</sup>	Quantity on the pallet, m <sup>2</sup>	Quantity in truck, length 13,6 m*, m <sup>2</sup>	Weight of a pallet, kg
<b>ULTRA series</b> EN 544	SONATA SAMBA	22 / 3,0	108	2 376	1047
	ACCORD JIVE	22 / 3,0	108	2 376	1047
<b>CLASSIC series</b> EN 544	ACCORD PRAGA	22 / 3,0	108	2 484	1036,2
	SONATA QUADRILLE	22 / 3,0	108	2 592	982,2
	TANGO SUPER	21 / 3,0	108	2 160	1144,2
	TRIO SUPER	21 / 3,0	108	2 052	1209
<b>YOGA series</b> ETA 09/0234	YOGA HEXAGONAL	14 / 2,0	150	2 700	1281
	YOGA BEAVER	14 / 2,0	132	2 376	1288,2
	YOGA TRIO	14 / 2,0	132	2 244	1354,2
<b>STANDARD ROCK series</b> ETA 12/0264	STANDART ROCK HEXAGONAL	22 / 3,0	135	2 835	1114,5
	STANDART ROCK BEAVER	21 / 3,0	126	2 520	1167,6
	STANDART ROCK TRIO	21 / 3,0	126	2 394	1243,2
<b>MIDA SELF KSK</b>	SELF-ADHESIVE ROOFING	1 / 2,5	175	13 440	686
	MIDA LIGHT G	40 / 10	400	12 800	741
<b>ACCESSORIES</b>	MIDA LIGHT S	40 / 10	400	13 200	693
	HIP AND RIDGE	20 / 5,0	200	4 600	1021

Most bitumen shingles are loaded on pallets 105×105 cm  
\* the load in a truck can not exceed a total weight of 24 000 kg.



**PITCHED ROOF  
CALCULATION  
SERVICE**

Gamyklos st. 19, LT-96155,  
Gargždai, Klaipėdos distr. LITHUANIA  
Tel. +370 700 44722  
e-mail: shinglas.support@mida.lt

**WWW.MIDA.LT**

